

MODEL 5-MT

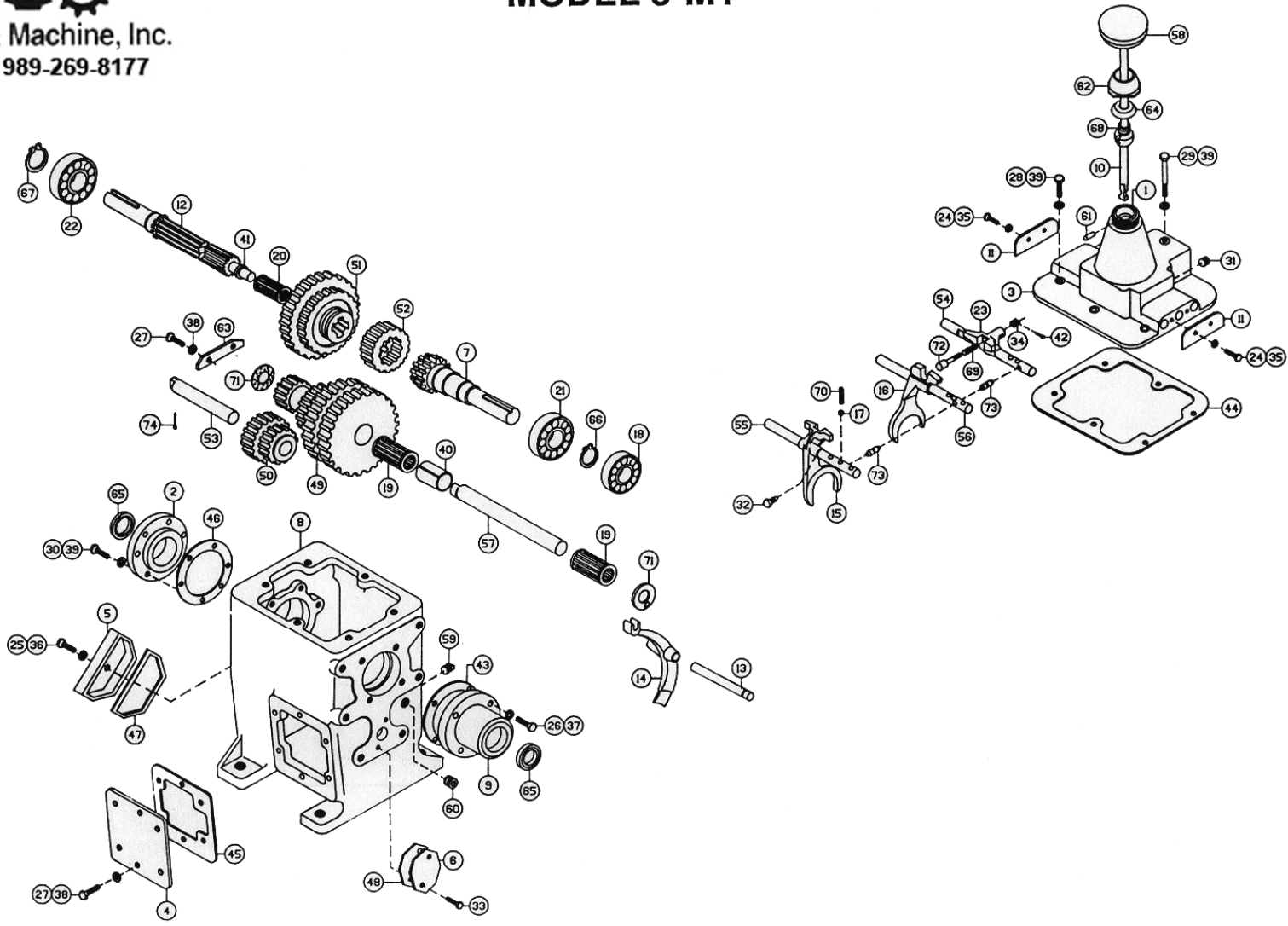

MODEL 5-MT
PART NO. R150102
HP RATING 50 @ 1,250 RPM
SERIES 5-M
SPEEDS 4 Forward/1 Rev.

Ratios
 1.000:1
 1.689:1
 3.095:1
 6.410:1
 7.812:1 Rev.

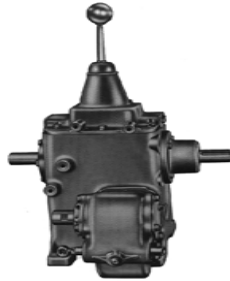

Item	Part No	Description	Qty	Item	Part No	Description	Qty
1	308052	Bushing	1	38	418179	Washer	8
2	316070	Bearing Cap	1	39	418184	Washer	16
3	328052	Shifter Head	1	40	418507	Spacer-Gear	1
4	328086	Cover Plate	1	41	418508	Spacer-Ring	1
5	328102	Cover	1	42	424001	Cotter Pin	1
6	328103	Cover	1	43	442029	Gasket	1
7	334062	Drive Gear	1	44	442031	Gasket	1
8	338098	Housing-Gear	1	45	442062	Gasket	1
9	338099	Housing-Brg	1	46	442156	Gasket	1
10	344038	Lever-Shifter	1	47	442173	Gasket	1
11	350538	Cover	2	48	442174	Gasket	1
12	356931	Shaft	1	49	444022	Gear-Cluster	1
13	357031	Shaft-Shifter	1	50	444023	Gear-Rev. Idler	1
14	358046	Shifter Fork	1	51	444024	Gear-Sliding	1
15	358047	Yoke-Shifter	1	52	444025	Gear-Sliding	1
16	358048	Yoke-Shifter	1	53	444026	Shaft-Idler	1
17	400003	Ball Poppet	3	54	444027	Shaft-Shift	1
18	402013	Bearing Cap	1	55	444028	Shaft-Shift	1
19	402018	Bearing-Roller	2	56	444029	Shaft-Shift	1
20	402019	Bearing-Roller	1	57	444032	Shaft-Gear	1
21	402022	Bearing-Ball	1	58	452002	Knob	1
22	402023	Bearing-Ball	1	59	468011	Pipe Plug	2
23	408005	Bracket	1	60	468018	Pipe Plug	1
24	414037	Cap Screw	4	61	470010	Dowel Pin	1
25	414040	Cap Screw	1	62	472005	Cap	1
26	414139	Cap Screw	6	63	474022	Retainer Plate	1
27	414230	Cap Screw	8	64	479003	Retainer Shaft	1
28	414281	Cap Screw	9	65	486068	Oil Seal	2
29	414244	Cap Screw	1	66	490009	Snap Ring	1
30	414282	Cap Screw	6	67	490015	Snap Ring	1
31	414971	Screw-Poppet	1	68	494014	Spring	1
32	416137	Set Screw	3	69	494015	Spring	1
33	416236	Screw	2	70	494016	Spring	4
34	418012	Nut-Castellated	1	71	518007	Thrustwasher	2
35	418149	Lockwasher	4	72	530001	Plunger	1
36	418154	Washer	1	73	530002	Pawl-Shifter	2
37	418163	Lockwasher	6	74	424006	Cotter Pin	1

Model 5MT

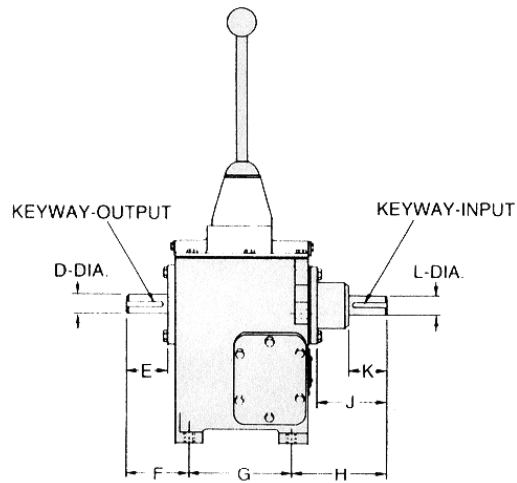
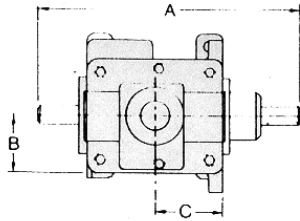

SPECIFICATIONS							
Model No.	Rating at 1200 RPM	Input to Output Ratios				Approx. Weight	
		Low	2nd	3rd	High	Reverse	Alum. Alloy
5M	50 HP	1:156	1:323	1:592	1:1	1:128	78 lbs.

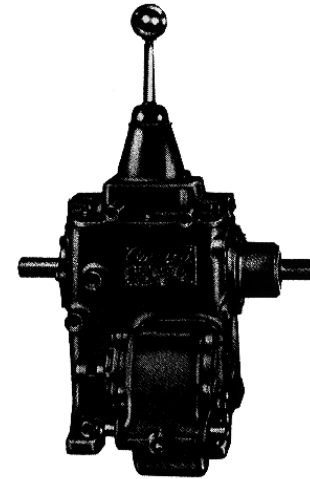
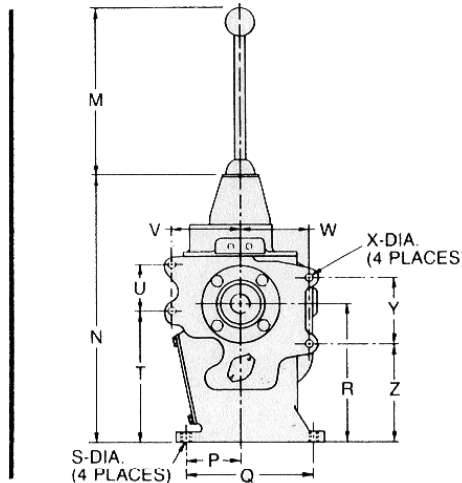

LETTERED DIMENSIONS

Model	A Inches MM	B Inches MM	C Inches MM	D Inches MM	E Inches MM	F Inches MM	G Inches MM	H Inches MM	J Inches MM	K Inches MM	L Inches MM	M Inches MM	N Inches MM
5MT	17.44 442.9	3.87 98.4	4.50 114.3	1.25 31.7	2.75 69.8	4.25 107.9	7.00 177.8	6.19 157.1	4.56 115.9	2.50 63.5	1.25 31.7	11.25 285.7	18.00 475.2
	P	Q	R	S	T	U	V	W	X	Y	Z	Keyway Input	Keyway Output
	3.75 94.0	8.50 215.9	9.31 236.5	.62-11UNC 3B THD.	8.81 223.8	3.06 77.8	4.50 114.3	5.00 127.0	.59 15.1	4.69 119.0	6.62 168.3	.31 (W) .16 (D) 2.25 (L)	.31 (W) .16 (D) 2.25 (L)